

記号	訂正記事	担当	日付	仕上		面取
△				FINISH		C.R
△				処理		
△				熟処理		

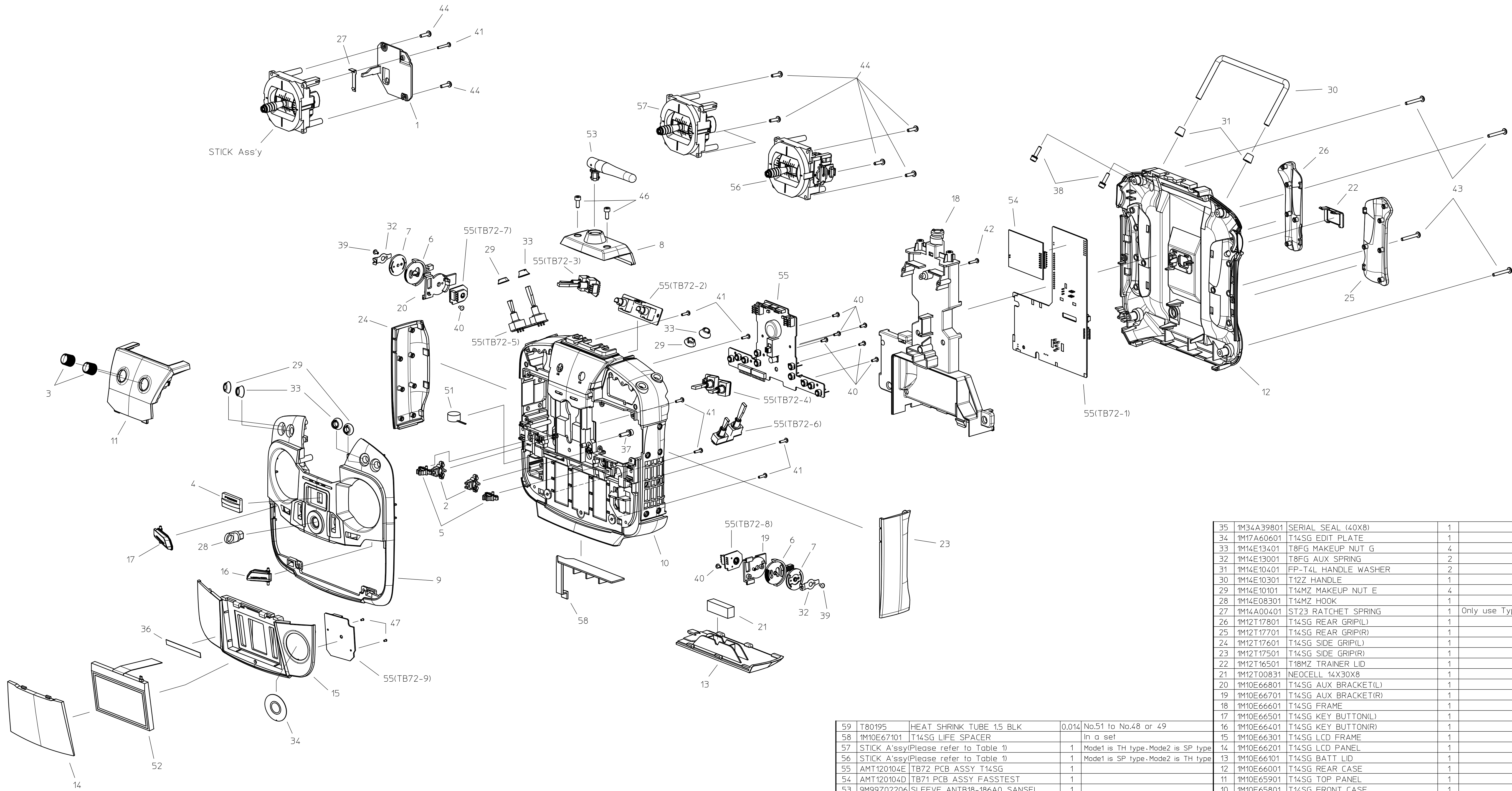

Table 1.

6	AMT150019H	STICK ST-57(TH)HT TF	○ J	○ U	○ P						
5	AMT150019G	STICK ST-57(TH)S TF				○ J/X			○ U		
4	AMT150019F	STICK ST-57(TH) TF									○ A
3	AMT150019E	STICK ST-57(SP)HT TF	○ J	○ U	○ P						
2	AMT150019D	STICK ST-57(SP)S TF				○ J/X					○ A
1	AMT150019C	STICK ST-57(SP) TF							○ U		
項目	コード番号	部品名	JPN	US	ERP	JPN/ASIA	US	ERP	AUST		
			Type A			Type H					

59	T80195	HEAT SHRINK TUBE 1.5 BLK	0,014	No.51 to No.48 or 49
58	1M10E67101	T14SG LIFE SPACER		In a set
57	STICK A'ssy(Please refer to Table 1)		1	Model1 is TH type, Model2 is SP type
56	STICK A'ssy(Please refer to Table 1)		1	Model1 is SP type, Model2 is TH type
55	AMT120104E	TB72 PCB ASSY T14SG	1	
54	AMT120104D	TB71 PCB ASSY FASSTEST	1	
53	9M99Z02206	SLEEVE ANT18-186A0_SANSEI	1	
52	9M15A03201	JYG-128640TG (R)-FS6L2-VA JIYA	1	
51	9M12A03301	TROICORE CV1102	1	
50	9M08A19201	CABLE MAIN-STK T8FG	2	From STICK to No.54(TB72-1)
49	9M00C0502G	C-WIRE 0.08/20(2-2) RED 50	1	From No.50 to No.54(TB72-1)
48	9M00C0500G	C-WIRE 0.08/20(2-2) BLACK 50	1	From No.50 to No.54(TB72-1)
47	8M00B06702	#0 KTP 1.4X2.5 ZN5 FE	2	
46	8M00B04205	HSB P-TITE 3X8 BZN3 FE	2	
45	8M00B00314	BTS(2) 2.6X8 CR FE	2	Only use Type ERP
44	8M00B00309	BTS(2) 2.6X10 BZN3 FE	6	
43	8M00B00304	BTS(2) 2.6X20 BZN3 FE	4	
42	8M00B00119	BTS(2) 2X12 BZN3 FE	1 (2)	Type ERP use 2pcs
41	8M00B00113	BTS(2) 2X8 BZN3 FE	6	
40	8M00B00106	BTS(2) 2X6 BZN3 FE	8	
39	8M00B00104	BTS(2) 2X4 BZN3 FE	2	
38	8M00A06803	SWW-HSB 3X12 NI FE	2	
37	8M00A06802	SWW-HSB 3X10 NI FE	1	
36	1M34A61105	NITTO 515 SHEET 50X5	1	
項目	コード番号	部品名	個数	摘要

35	1M34A39801	SERIAL SEAL (40X8)	1	
34	1M17A60601	T14SG EDIT PLATE	1	
33	1M14E13401	T8FG MAKEUP NUT G	4	
32	1M14E13001	T8FG AUX SPRING	2	
31	1M14E10401	FP-T4L HANDLE WASHER	2	
30	1M14E10301	T12Z HANDLE	1	
29	1M14E10101	T14MZ MAKEUP NUT E	4	
28	1M14E08301	T14MZ HOOK	1	
27	1M14A00401	ST23 RATCHET SPRING	1	Only use Type ERP
26	1M12T17801	T14SG REAR GRIP(L)	1	
25	1M12T17701	T14SG REAR GRIP(R)	1	
24	1M12T17601	T14SG SIDE GRIP(L)	1	
23	1M12T17501	T14SG SIDE GRIP(R)	1	
22	1M12T16501	T18MZ TRAINER LID	1	
21	1M12T00831	NEOCELL 14X30X8	1	
20	1M10E66801	T14SG AUX BRACKET(L)	1	
19	1M10E66701	T14SG AUX BRACKET(R)	1	
18	1M10E66601	T14SG FRAME	1	
17	1M10E66501	T14SG KEY BUTTON(L)	1	
16	1M10E66401	T14SG KEY BUTTON(R)	1	
15	1M10E66301	T14SG LCD FRAME	1	
14	1M10E66201	T14SG LCD PANEL	1	
13	1M10E66101	T14SG BATT LID	1	
12	1M10E66001	T14SG REAR CASE	1	
11	1M10E65901	T14SG TOP PANEL	1	
10	1M10E65801	T14SG FRONT CASE	1	
9	1M10E65701	T14SG FRONT PANEL	1	
8	1M10E62501	T18MZ TOP CASE	1	Type K0R use 1M10E62502
7	1M10E55601	T8FG AUX BRACKET B	2	
6	1M10E55302	T8FG AUX LEVER(2)	2	
5	1M10E54601	T8FG TRIM LEVER D2	2	
4	1M10E54501	T8FG MAIN SW KNOB(TP40) CR	1	
3	1M10E47201	T12FG TOP VR KNOB(TP40) CR	2	
2	1M10E34102	T14MZ TRIM LEVER B2	2	
1	1M10A22001	ST56 STICK COVER	1	Only use Type ERP
項目	コード番号	部品名	個数	摘要
		材質	材厚	個数
		三角法	1/2	名称
				EPD_T18MZ
				名称
				2013.01.11
				日付
				名称
				1M50A298**
				部品番号
				PART NO
				図番
				1M50A298
				DWGNo
				改訂番号